

	KG	WINDAGE
ZEBSTAR	15.00kg	0.72 m ²
ZEBSTAR+	15.75kg	0.74 m ²

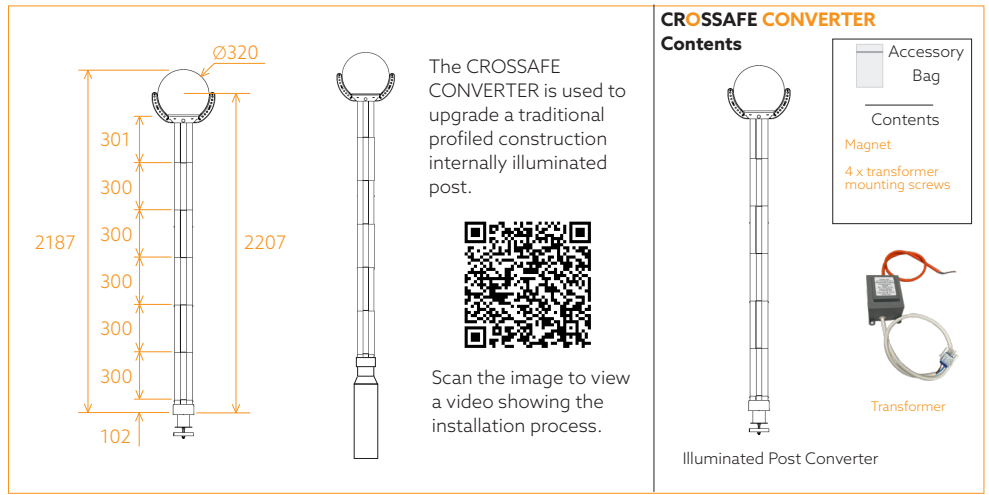
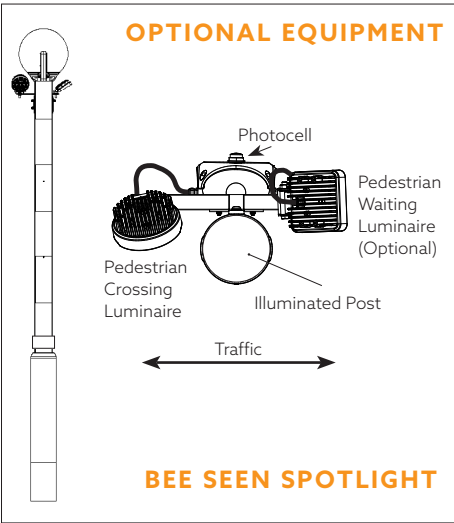

- ⚠️ Disconnect from the supply when conducting in-situ insulation resistance testing.
- ⚠️ If the external flexible cable or cord of this product is damaged, it shall be exclusively replaced by the manufacturer or his service agent or a similar qualified person in order to avoid a hazard.
- ⚠️ The light source (LED's) contained in this product shall only be replaced by the manufacturer or his service agent or a similar qualified person.

SAFETY FIRST

Isolate the electrical supply before commencing any installation or maintenance work. Wiring should be carried out in accordance with the latest IEE regulations by suitably qualified engineers. This equipment is designed for 24 volt AC operation and must be used with a suitable transformer when connected to the mains supply. Please review this guide and carry out a site risk assessment before commencing work.

TOOLS REQUIRED

- Post cutting saw (Hand held band saw recommended)
- 8mm drill
- 17mm Ratchet Spanner
- Philips screwdriver

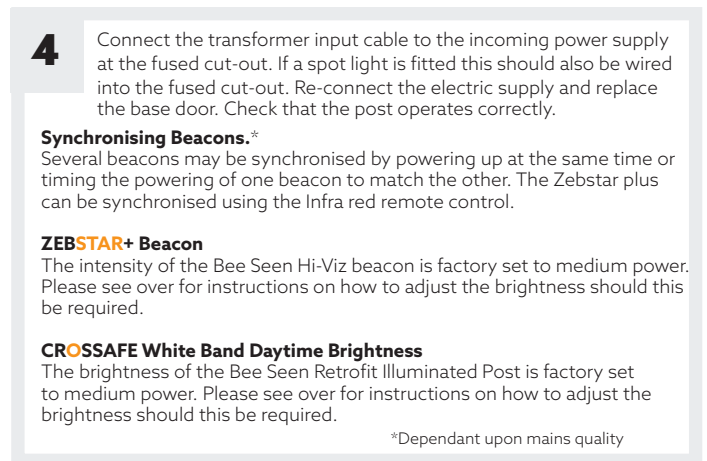
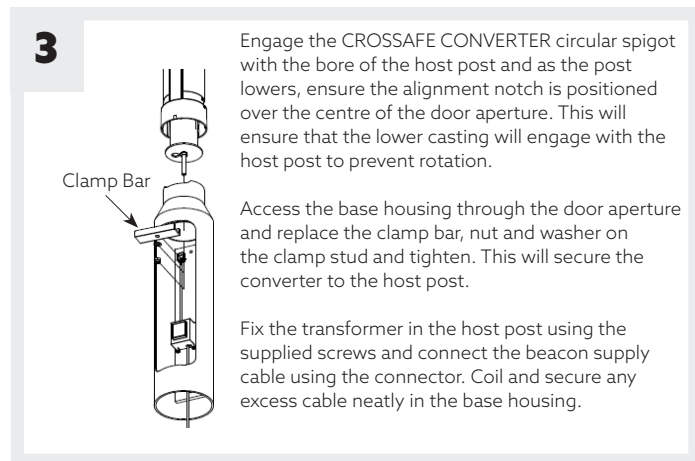
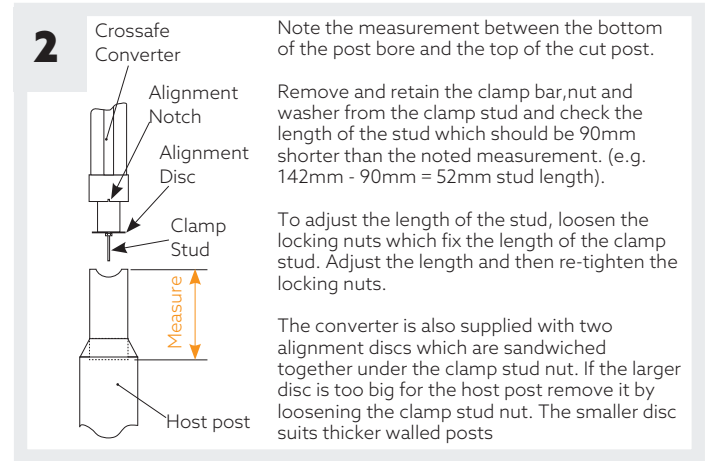
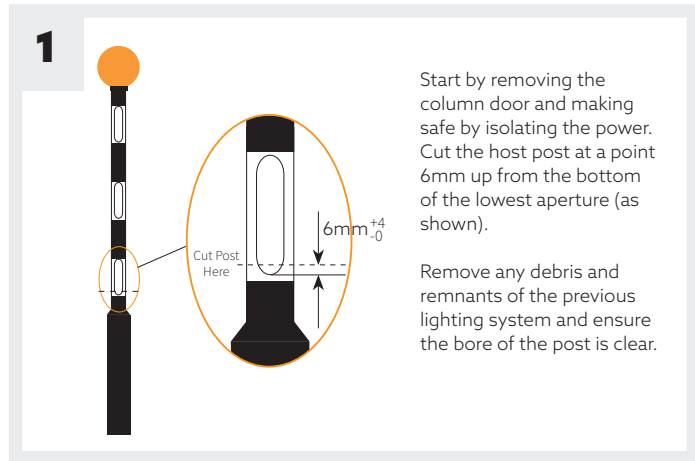

BEE SEEN ZEBSTAR+ BEACON BRIGHTNESS ADJUSTMENT

The Bee Seen ZEBSTAR+ beacon has an adjustable array brightness which is independent between front and back. Follow the steps below to access the controls and make the adjustment.

SAFETY FIRST

Isolate the electrical supply before commencing any installation or maintenance work. Wiring should be carried out in accordance with the latest IEE regulations by suitably qualified engineers.

This equipment is designed for 24 volt AC operation and must be used with a suitable transformer when connected to the mains supply.

TOOLS REQUIRED

- 4mm Allen key
- Small terminal screwdriver.

1

Isolate the beacon power supply then remove the beacon globe which will allow access to the brightness adjustment controls.

To do this, locate the four Beacon fixing screws which should be loosened with the 4mm Allen key.

When loosened fully, lift off the beacon globe. The screws are retained in the beacon gallery.

2

Identify the control board in the base of the beacon gallery and locate the array adjustment controls. There are two controls, each offering 8 levels of adjustment to the front and back projection. Note the white arrows printed on the board indicate which side of the beacon will be adjusted by each control.

The table below shows the level brightness for each setting.

Rotate the control with a small flat screwdriver to the desired setting.

The setting can be checked visually before replacing the beacon globe by temporarily powering up the beacon.

Take care to protect eyes when performing the check.

3

Replace the beacon globe onto the gallery with the moulding seam running from side to side. Check that the sealing 'O' ring has not been dislodged and reposition in its groove if required.

Re-tighten the four globe fixing screws to secure the globe in place.

Re-connect the electric supply and replace the base door. Check that the beacon operates correctly.

BRIGHTNESS LEVEL SETTINGS

LEVEL	Output Brightness (cd/m ²)	
	DAY	NIGHT
0	OFF	OFF
1	1160	OFF
2	761	761
3	980	761
4	1160	761
5	1473	761
6	1503	761
7	1570	761

BEE SEEN CROSSAFE BRIGHTNESS ADJUSTMENT

The white band illumination brightness can be adjusted to suit site conditions to make the post more visible to drivers.

Hold the supplied magnetic wand on the marked area within the lowest black band. A red dot will illuminate on the display to show that the system is active. Keep the magnet in place for around 10 seconds when the display will illuminate to show the current lighting level. Swiping the magnet across the area will advance the lighting level making the post brighter. When level 7 is reached, a further swipe will return to setting 0.

When the desired level is selected remove the magnet and after a short delay the display will flash indicating that the new level has been stored. At this point the post may dim slightly which will be the post responding to the ambient lighting conditions.

Repeat the process on both sides of the post which are independent from each other.

LEVEL	White band Brightness (cd/m ²)	
	Daytime	Night-time
0	OFF	OFF
1	591	858
2	858	858
3	2,440	858
4	3,733	858
5	5,097	858
6	6,311	858
7	7,172	858